

BALLARD™ ORAL CARE

REMINDER! KEEP THE SUCTION HANDLE ATTACHED AT ALL TIMES.

- Suction handle connects to ALL tools
- 1/4 turn twist secures components in place
- On/Off switch allows for easy control
- Connect each tool and follow the kit in order

See IFU for full warnings and instructions

A 1/4 TURN TWIST WILL SECURE COMPONENTS IN PLACE

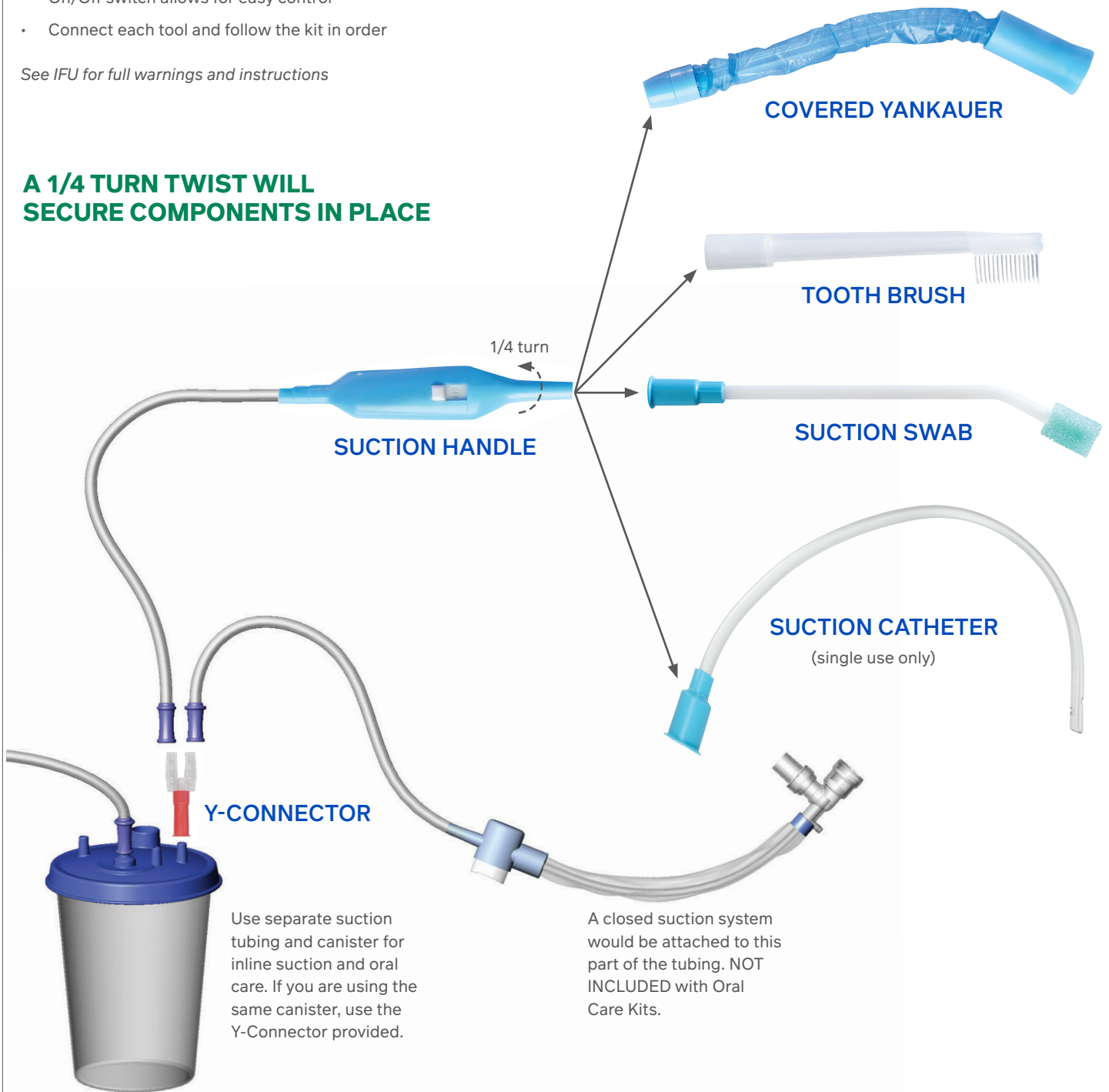

Use separate suction tubing and canister for inline suction and oral care. If you are using the same canister, use the Y-Connector provided.

A closed suction system would be attached to this part of the tubing. NOT INCLUDED with Oral Care Kits.